

CITY OF MARSHALL, TEXAS
2023

GENERAL NOTES FOR PROJECT

1. ALL UTILITIES SHOWN ON THE PLANS HAVE NOT BEEN FIELD VERIFIED, LOCATIONS SHOWN FOR EXISTING UTILITIES ARE APPROXIMATE AND OTHER UTILITIES MAY EXIST IN THE VICINITY OF THIS PROJECT WHICH ARE NOT SHOWN ON THESE PLANS. CONTRACTOR SHALL UNCOVER ALL EXISTING UTILITIES AND VERIFY EXISTING ELEVATIONS OF SAME AT ALL PROPOSED CROSSINGS AND PROPOSED CONNECTIONS BEFORE COMMENCING WORK. ALL CONFLICTS SHALL BE REPORTED TO THE ENGINEER IMMEDIATELY.
- CITY OF MARSHALL – (903) 935–4489
TEXAS811 – 811
TXU – LONE STAR GAS – ONCOR – (903) 242–4830 (BOBBY FOWLER)
RELIANT ENERGY – ENTEX GAS – (903) 759–7133 (BUBBA VRANA)
*AEP – SWEPCO – (903) 234–7243 (RONNEY ORTIGO)
(903) 234–7244 (TOMMY FARNHAM)
- *NOTE THAT A TWO (2) WEEK NOTICE IS REQUIRED PRIOR TO CONSTRUCTION FOR AEP – SWEPCO
- SOUTHWESTERN BELL TELEPHONE – (800) 395–0440
SPRINT TELEPHONE – (800) 521–0579
MCI TELEPHONE – (800) 344–8377
AT&T TELEPHONE – (800) 252–1133
SUN PIPELINE CO. – MID–VALLEY – (903) 297–1311
PLAINS PIPELINE – (800) 708–5071
EL PASO FIELD SERVICES – (903) 663–2477
EL PASO PRODUCTION – HUNT – (903) 930–0483 (GENE VINCENT)
GULF SOUTH PIPELINE CO. (903) 736–6172 (LEWIS(HOOT) GIBSON)
(903) 736–2101 (KEITH WILLIAMSON)
KOCH MIDSTREAM SERVICES CO. – EMBRIDGE – (903) 736–3943 (JOEY WHITESIDE)
SONAT PIPELINE – HUNT – (903) 930–0483 (GENE VINCENT)
LDDS WORLD COM – 1–800–248–0133
2. CONTRACTOR SHALL NOTIFY CITY OF MARSHALL 48 HOURS IN ADVANCE OF COMMENCING CONSTRUCTION AT 903–935–4489.
3. CONTRACTOR SHALL PROVIDE TRENCH SAFETY SYSTEMS MEETING OSHA STANDARDS, CHAPTER XVII, SECTION 1926.650 SUBPART P. "EXCAVATIONS, TRENCHING AND SHORING", WHERE APPLICABLE.
4. GUIDELINES SET FORTH IN PART VI (TEMPORARY TRAFFIC CONTROL) OF THE TEXAS MANUAL OF UNIFORM TRAFFIC CONTROL DEVICES (MOST RECENT EDITION AS REVISED) SHALL BE OBSERVED. THE COST FOR ALL TRAFFIC CONTROL MEASURES SHALL BE PAID AS A LUMP SUM.
5. IN ALL FILL AREAS, LIFTS SHALL BE A MAXIMUM OF 8" AND COMPACTED TO 95% DENSITY AT ±3% OPTIMUM MOISTURE PER ASTM D–698 (STANDARD PROCTOR) UNLESS OTHERWISE NOTED ON THE PLANS.
6. ALL EXCESS DIRT & SPOIL MATERIAL FROM CONSTRUCTION OF PROPOSED IMPROVEMENTS SHALL BE REMOVED FROM THE JOB SITE AT NO COST TO THE OWNER, AND DISPOSED OF BY THE CONTRACTOR AT A PERMITTED FACILITY.
7. ALL ITEMS DESIGNATED FOR REMOVAL FROM THE SITE SHALL BE DISPOSED OF AT AN APPROVED DISPOSAL SITE AT NO EXTRA PAY.
8. CONTRACTOR IS CAUTIONED THAT OVERHEAD AND UNDERGROUND UTILITIES EXIST AT THE PROJECT SITE AND THE APPROPRIATE UTILITIES SHOULD BE NOTIFIED PRIOR TO COMMENCING WORK. CONTRACTOR SHALL COMPLY WITH ALL APPLICABLE LAWS REGARDING PUBLIC & WORK SAFETY.
9. CONTRACTOR SHALL GRADE THE SITE SUCH THAT ALL DISTURBED AREAS DRAIN FREELY WITH UNIFORM, GENTLY SLOPING GRADES AS THE WORK PROGRESSES ALONG THE PROJECT. CONTRACTOR SHALL KEEP CONSTRUCTION SITE FREE OF SCATTERED MATERIALS AND DEBRIS. SITE GRADING AND CLEANUP SHALL BE PERFORMED AS WORK PROGRESSES ALONG THE PROJECT.
10. A STORMWATER POLLUTION PREVENTION AND EROSION CONTROL PLAN IN ACCORDANCE WITH THE REQUIREMENTS IN THE JULY 6, 1998 FEDERAL REGISTER, IS THE RESPONSIBILITY OF THE CONTRACTOR. THE CONTRACTOR SHALL PREPARE THE SWPPP PRIOR TO COMMENCING CONSTRUCTION ACTIVITIES, THE SWPPP CONTAINS THE NECESSARY INFORMATION AS MANDATED IN THE 7/6/98 FEDERAL REGISTER, INCLUDING BUT NOT LIMITED TO, NOTICES OF INTENT, BEST MANAGEMENT PRACTICES, GOOD HOUSEKEEPING MEASURES, INSPECTION PROCEDURES, ETC. THE COMPLETE SWPPP EXCEPT FOR THE INSPECTION AND MAINTENANCE REPORT FORMS, WILL BE RETAINED IN THE CONTRACT DOCUMENTS DURING CONSTRUCTION.
11. CONTRACTOR SHALL RELOCATE ALL EXISTING SIGNAGE, MAILBOXES, REFLECTORS, ETC., TO APPROPRIATE LOCATION DURING CONSTRUCTION AND SHALL REINSTALL SAME AFTER COMPLETION OF SITE GRADING AND CLEANUP.
12. THE SAW–CUTS REQUIRED TO BITUMINOUS OR CONCRETE PAVEMENT, CURB, GUTTER, SIDEWALKS, OR DRIVEWAYS SHALL NOT BE MEASURED FOR PAYMENT AND SHALL BE CONSIDERED SUBSIDIARY TO THE ITEMS REQUIRING SAWING.
13. THE CONTRACTOR IS RESPONSIBLE FOR OBTAINING WRITTEN AUTHORIZATION OF APPROVAL FOR WASTE DISPOSAL FROM ALL PROPERTY OWNERS WHO ACCEPT PROJECT WASTE MATERIAL. A COPY OF THE WRITTEN AUTHORIZATION SHALL BE PROVIDED TO THE CITY.

14. ALL CONCRETE SHALL BE CLASS "A", 3000 PSI @ 28 DAYS UNLESS OTHERWISE NOTED. ALL REINFORCING STEEL TO BE GRADE 60.
15. ALL WORK & MATERIALS SHALL BE SUBJECT TO THE PROJECT ENGINEER'S AND THE CITY ENGINEER'S APPROVAL DURING CONSTRUCTION AND UPON COMPLETION.
16. CONTRACTOR SHALL KEEP DIRT, MUD, AND DEBRIS OFF OF PUBLIC STREETS IN THE PROJECT AREA. CONTRACTOR SHALL IMMEDIATELY CLEAN DIRT, MUD, AND DEBRIS FROM PUBLIC STREETS AS SOON AS IT IS NOTICED BY THE CONTRACTOR OR NOTIFIED BY THE ENGINEER OR OWNER.
17. STOCKPILING OF MATERIALS ON PRIVATE PROPERTY WILL NOT BE PERMITTED WITHOUT WRITTEN PERMISSION FROM THE PROPERTY OWNER.
18. ALL UTILITY SERVICE LINES BROKEN OR INTERRUPTED BY THE CONTRACTOR'S OPERATIONS SHALL BE REPAIRED IMMEDIATELY AT THE CONTRACTOR'S EXPENSE.
19. CONTRACTOR IS RESPONSIBLE FOR ALL DEWATERING NECESSARY FOR THE PROPER CONSTRUCTION OF THE PROPOSED IMPROVEMENTS.
20. ALL STORMWATER POLLUTION AND PREVENTION SILT FENCES AND HAY BALE DIKES, ETC. SHALL BE REMOVED UPON COMPLETION OF PROJECT.
21. CONTRACTOR SHALL MAINTAIN TEMPORARY ACCESS TO ALL BUILDINGS DURING CONSTRUCTION. CONTRACTOR SHALL COORDINATE WITH BUSINESS OWNERS AND PROVIDE ADVANCE NOTICE OF 48 HOURS FOR ANY NECESSARY DISRUPTIONS AND OBTAIN APPROVAL BY OWNER.
22. CONTRACTOR SHALL PROTECT BUILDING WALLS, DOORWAY THRESHOLDS, ENTRY TILES, ETC. FROM CONCRETE SPLATTER DURING CONSTRUCTION.
23. CONTRACTOR MAY CLOSE STREET TO ONE WAY TRAFFIC PROVIDED AN APPROVED TRAFFIC CONTROL PLAN IS APPROVED BY THE CITY ENGINEER. CONTRACTOR MAY CLOSE UP TO 1/2 OF THE AVAILABLE PARKING SPACES FOR THE BLOCK AT ANY GIVEN TIME. CONTRACTOR MUST MAINTAIN ACCESS TO ALL BUSINESSES EXCEPT IN PRE–APPROVED COORDINATED CLOSURE TIMES.

GENERAL NOTES FOR HISTORIC ITEMS

PROTECTION NOTES FOR THE REMOVAL OF EXISTING PAVEMENT, CURB OR SIDEWALK AND CONSTRUCTION OF NEW PAVEMENT, CURB OR SIDEWALK ADJACENT TO HISTORIC BUILDINGS, CANOPIES, MATERIALS, FENCES, AND RETAINING WALLS

Where proposed work is in proximity to historic buildings or other structures (walls, canopies, retaining walls, fences), and planting beds, and vegetation/groundcover, follow the procedures listed below for demolition, protection, and construction at these addresses:

In the city of MARSHALL , at ALL BLDGS. (list addresses):

1. To minimize potential damage to historic structures and materials, contractor to saw cut existing sidewalk 8 to 12 inches away from the historic structure, canopy supports, fence, or retaining wall.

2. Contractor to construct new sidewalk next to the saw cut edge with installation of expansion joint in between. If existing sidewalk is to be removed entirely, the remaining 8 to 12 inches next to the historic structure, canopy supports, material, fence, or retaining wall will be removed by hand. Expansion joint to be placed between historic structure, canopy support, material, fence, or retaining wall and new sidewalk.

3. Contractor is responsible for preventing damage to historic structure, canopy supports and their awning, materials, fences, retaining walls, including garden elements (planting beds, plantings) during the entire construction project, especially during removal of existing pavement, curb, or sidewalk. During the saw cut and hand removal process, contractor will exercise utmost caution and will physically protect historic structure foundation, canopy supports, materials, elevations, entryways with decorative flooring, fences, retaining walls, and landscape elements.

4. Contractor to repair or replace in kind, at his own expense, any historic materials damaged in the course of executing the work. Contractor is responsible for locating replacement source for historic materials damaged in the course of the work. Texas Historical Commission to be informed of damage and proposed repairs prior to execution of repair work.

SHEET INDEX

SHEET NO.	DESCRIPTION
1	TITLE SHEET & VICINITY MAP
2	GENERAL NOTES & SHEET INDEX
3	EXISTING SITE PLAN–300 BLOCK
4	PROPOSED SITE PLAN–300 BLOCK
5	DEMOLITION PLAN–300 BLOCK
6	STORM SEWER PLAN–300 BLOCK
7	LAYOUT AND GRADING PLAN–300 BLOCK
8	LAYOUT AND GRADING PLAN–300 BLOCK
9	CONCRETE JOINT LAYOUT PLAN–300 BLOCK
10	LANDSCAPING PLAN–300 BLOCK
11	LIGHTING PLAN–300 BLOCK
12	EXISTING SITE PLAN–400 BLOCK
13	PROPOSED SITE PLAN–400 BLOCK
14	DEMOLITION PLAN–400 BLOCK
15	STORM SEWER PLAN–400 BLOCK
16	LAYOUT AND GRADING PLAN–400 BLOCK
17	LAYOUT AND GRADING PLAN–400 BLOCK
18	CONCRETE JOINT LAYOUT PLAN–400 BLOCK
19	LANDSCAPING PLAN–400 BLOCK
20	LIGHTING PLAN–400 BLOCK
21–24	PEDESTRIAN FACILITIES, CURB RAMPS
25	MISCELLANEOUS DETAILS 1
26	MISCELLANEOUS DETAILS 2
27	MISCELLANEOUS DETAILS 3
E1–E3	ELECTRICAL DETAILS

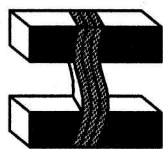

DRAWN BY : R.L.C.
CHECKED BY : S.R.H.
DATE : SEPT. 2023
SCALE : AS NOTED
JOB NO. : MA-21-01
MA-22-04

SHEET

2

OF 27 SHEETS

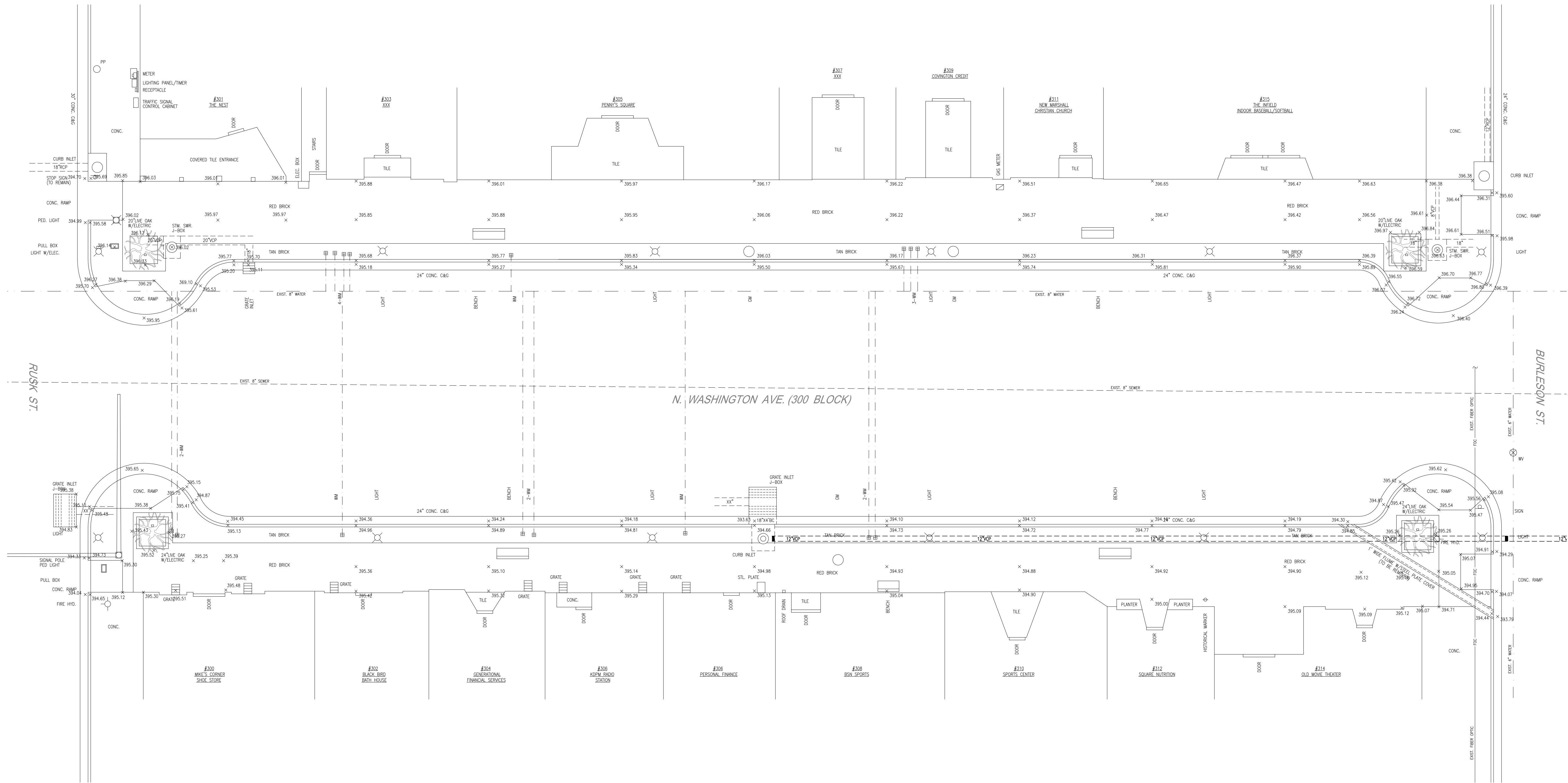
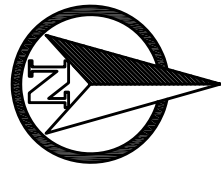

EXISTING SITE
PLAN - 300 BLOCK

CITY OF MARSHALL, TX.
DOWNTOWN REDEVELOPMENT PHASE III
300 & 400 BLOCK OF N. WASHINGTON AVENUE

HAYES ENGINEERING, INC.
Texas Registered Engineering Firm F-1465
2126 Alpine St. Longview, TX 75601-3401
Tel.: (903) 758-2010 • Fax: (903) 758-2099

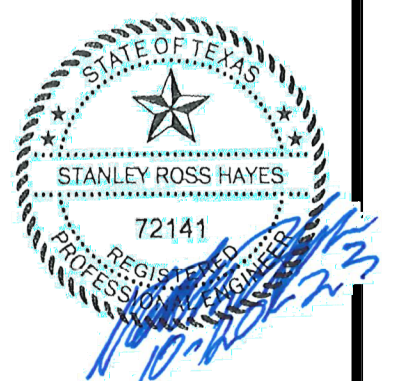
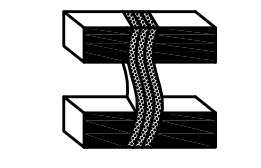

DRAWN BY : R.L.C.
CHECKED BY : S.R.H.
DATE : SEPT. 2023
SCALE : 1"=10'
JOB NO. : MA-21-01
MA-22-04

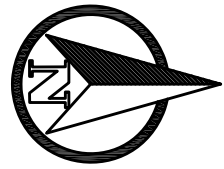

PROPOSED IMPROVEMENTS (ILLUSTRATIVE)
(REFER TO "BID PROPOSAL" IN SPECIFICATIONS FOR ACTUAL BID/PAYMENT ITEMS)

- ① PROPOSED 5' STORM SEWER CURB INLET (1 EA.)
- ② PROPOSED EXIST. MODIFIED ORNAMENTAL STREET LIGHT (12 EACH) WITH NEW FOUNDATION.
- ③ PROPOSED NEW CONCRETE FLATWORK, INCLUDING UNDER BRICK INLAY. (7,050 S.F.)
- ④ PROPOSED NEW BRICK PAVER INLAY ON SAND CUSHION. (1,970 S.F.)
- ⑤ PROPOSED PEDESTRIAN CURB RAMP RECONSTRUCTION. (TYPE I) (8 EACH) (ASSOCIATED 24" CURB & GUTTER AND 5'x5' LANDING TO BE INCLUDED IN BID PRICE)
- ⑥ PROPOSED NEW LANDSCAPE WELL WITH TREE GRATE. (10 EACH)
- ⑦ PROPOSED NEW BENCH, TRASH RECEPTACLE OR PLANTER. (6 EACH)
- ⑧ PROPOSED NEW 24" CONCRETE CURB AND GUTTER. (532 L.F.)
- ⑨ PROPOSED NEW TREE WITH ROOT BARRIER "SURROUND" (10 EACH)
- ⑩ PROPOSED STOP/ONE WAY SIGN (2 EA.)
- ⑪ PROPOSED WATER SERVICE, METER & QUICK COUPLER VALVE (2 EACH)
- ⑫ PROPOSED ASPHALT PATCH INCLUDING SAW CUTS-2' & 5' WIDE (161 S.Y.)
- ⑬ PROPOSED 8" WIDE WHITE CROSSWALK STRIPING-6" INSIDE/INSIDE (380 L.F.) (TXDOT ITEM 666, TYPE II). OBLITERATE EXISTING 4" CROSSWALK STRIPING.
- ⑭ PROPOSED 12" RCP STORM SEWER (168 L.F.)

NOTES

1. CONTRACTOR SHALL REMOVE & SALVAGE ANY BRICK PAVERS WHICH ARE NOT STUCK TO EXISTING CONCRETE BASE AND PLACE ON A PALLET AND LOADED ONTO A TRAILER PROVIDED BY THE CITY OF MARSHALL. IT IS ANTICIPATED THAT THIS COULD BE A COUPLE OF PALLETS.
2. EXISTING ORNAMENTAL LIGHTS, BENCHES, TRASH CANS, PLANTERS, ETC. BELONGING TO THE CITY OF MARSHALL SHALL BE SALVAGED AND DELIVERED TO A LOCATION SPECIFIED BY THE CITY OF MARSHALL.
3. CONTRACTOR SHALL PROTECT ALL OVERHEAD CANOPIES & AWNINGS.
4. CONTRACTOR SHALL ADJUST ALL UTILITY BOXES/ITEMS TO NEW SIDE-WALK GRADE AS NECESSARY.
5. CONTRACTOR SHALL ASSIST BUSINESS OWNERS IN RELOCATING PRIVATE OWNED ITEMS IN THE LINE OF CONSTRUCTION. (ON-SITE ONLY AT NO DIRECT PAY)
6. CONTRACTOR SHALL REPAIR AND/OR REPLACE EXISTING PAVEMENT MARKINGS REMOVED OR DAMAGED BY CONSTRUCTION ACTIVITIES. USE REFLECTORIZED TRAFFIC PAINT, MATCHING EXISTING COLOR AND WIDTH. (NO DIRECT PAY)

ORNAMENTAL BENCHES, TRASH RECEPTACLES & PLANTERS

MANUFACTURER-DUMOR, INC.
MIFFLINTOWN, PA.
TEL.: 1-800-598-4018
DUMOR.COM
(OR PRIOR APPROVED EQUAL)

BENCHES: 58-60 6' CAST BENCH, STEEL SEAT

TRASH REC.: 102-32SH 32 GAL. STEEL REC. W/SHIELD
& RECYCLED LID, 4" OPENING

PLANTER: 22-00SH STEEL PLANTER W/SHIELD

CONTRACTOR SHALL FURNISH 6 BENCHES, 6 TRASH RECEPTACLES AND 6 PLANTERS. CONTRACTOR SHALL INSTALL THESE ITEMS AT LOCATIONS DETERMINED BY THE CITY OF MARSHALL.

NEW BRICK PAVERS

MANUFACTURER- ACME BRICK
COLOR: PATHWAY RED

ALL NEW BRICK PAVERS INSTALLED SHALL BE UNIFORM IN COLOR AND ACCEPTABLE TO THE CITY OF MARSHALL.

NEW BRICK PAVERS DAMAGED OR CHIPPED DURING PLACEMENT MUST BE REMOVED AND REPLACED.

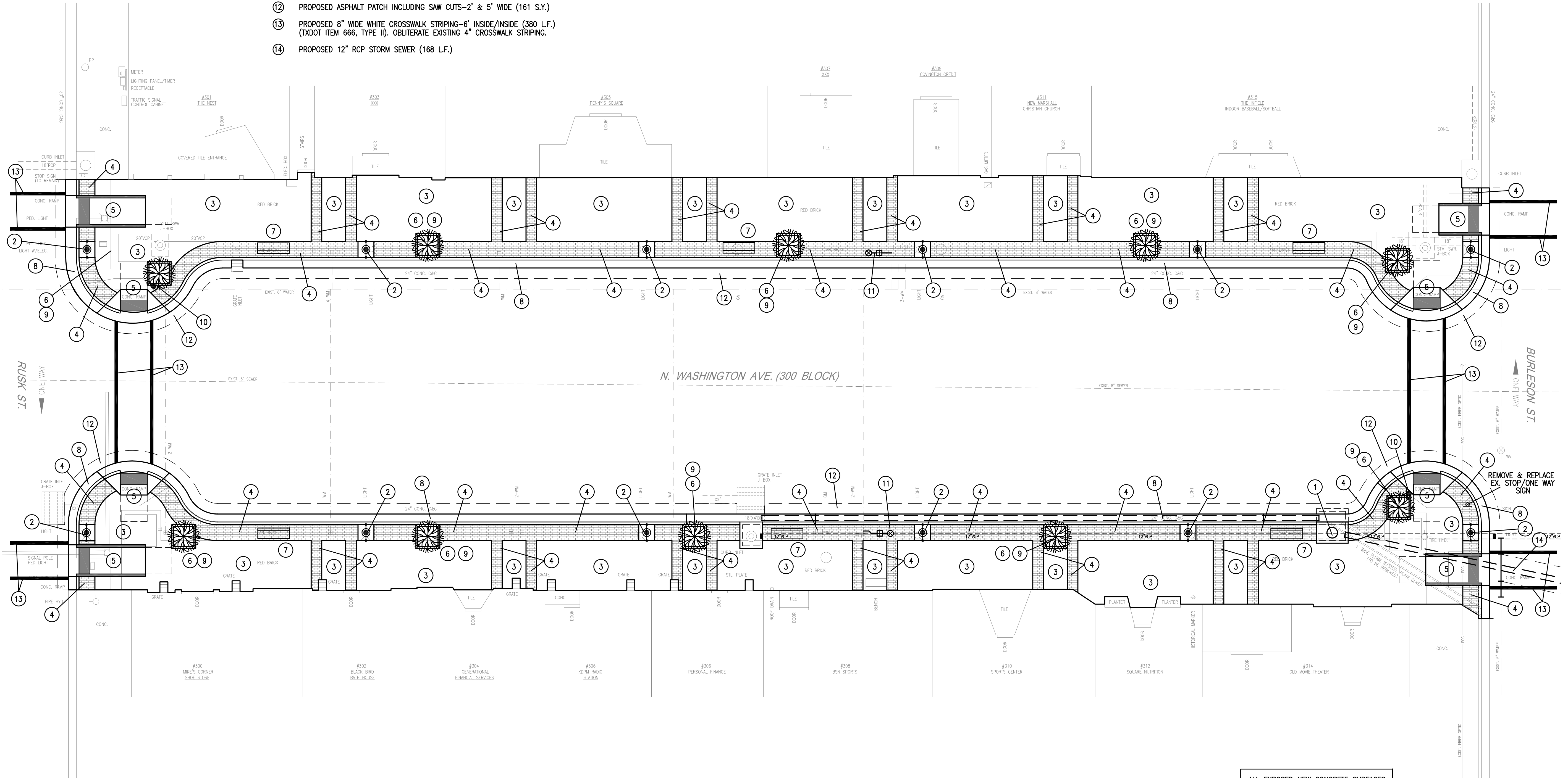

ALL EXPOSED NEW CONCRETE SURFACES SHALL HAVE A LIGHT BROOM FINISH.

**PROPOSED SITE
PLAN - 300 BLOCK**

CITY OF MARSHALL, TX.
DOWNTOWN REDEVELOPMENT PHASE III
300 & 400 BLOCK OF N. WASHINGTON AVENUE

HAYES ENGINEERING, INC.

Texas Registered Engineering Firm F-1465
2126 Alpine St. Longview, TX 75601-3401
Tel.: (903) 758-2010 • Fax: (903) 758-2099

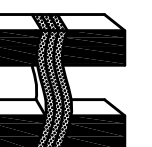

DRAWN BY : R.L.C.
CHECKED BY : S.R.H.
DATE : SEPT. 2023
SCALE : 1"=10'
JOB NO. : MA-21-01
MA-22-04

SHEET

4

OF **27** SHEETS

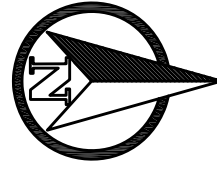

(REFER TO "BID PROPOSAL" IN SPECIFICATIONS FOR ACTUAL BID/PAYMENT ITEMS)

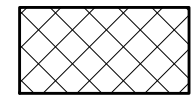

REMOVE AND DISPOSE OF EXISTING ASPHALT PAVING
AND BASE AS REQUIRED (APPROX. 161 S.Y. TOTAL)

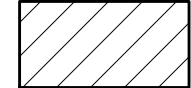

REMOVE AND DISPOSE OF EXISTING CONCRETE ADA RAMP
AND BASE AS REQUIRED (8 EA.)

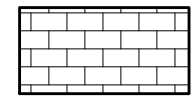

REMOVE EXISTING BRICK SIDEWALK PAVING, INCLUDING
1-5/8" BRICK, 1" GROUT, 4" CONCRETE BASE.
(APPROX. 7,442 S.F. TOTAL)

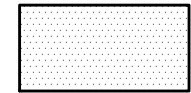

REMOVE AND DISPOSE OF EXISTING CURB & GUTTER
(APPROX. 634 L.F.)



REMOVE EXISTING ORNAMENTAL LIGHT POLE & FOUNDATION (12 EACH) (A)
(ORNAMENTAL LIGHT POLE/FIXTURE TO BE MODIFIED AND
RE-USED ON NEW FOUNDATION-SEE LIGHTING PLAN)



REMOVE EXISTING PED LIGHTS & FOUNDATIONS (2 EACH) (B)



REMOVE EXISTING SIGNAL LIGHT POLES, ARMS, FOUNDATIONS, (1 EACH) (C)
CONTROL CABINET, WIRING AND CAP ABANDONED CONDUITS
(REMOVE ALL TRAFFIC SIGNAL ITEMS AND DEVICES)

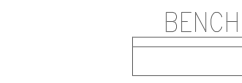

REMOVE EXISTING BENCH (4 EACH) (D)

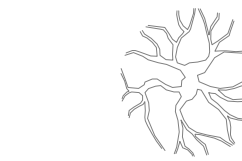

REMOVE TREES AND ELECTRIC (4 EACH) (E)



REMOVE CONCRETE TREE BOXES (3 EACH) (F)



REMOVE 1' WIDE CONC. FLUME W/STEEL PLATES (33 L.F.) (G)

NOTES

1. CONTRACTOR MAY REMOVE SIGNAL POLE FOUNDATIONS TO A DEPTH ONE FOOT BELOW SUBGRADE ELEVATION. SIGNAL POLES SHALL BE SALVAGED AND DELIVERED TO THE CITY OF MARSHALL STORAGE FACILITY.
2. CONTRACTOR SHALL SALVAGE TREE TRUNKS 12 INCH IN DIAMETER AND LARGER AND PLACE THEM ON A TRAILER PROVIDED BY THE CITY OF MARSHALL.

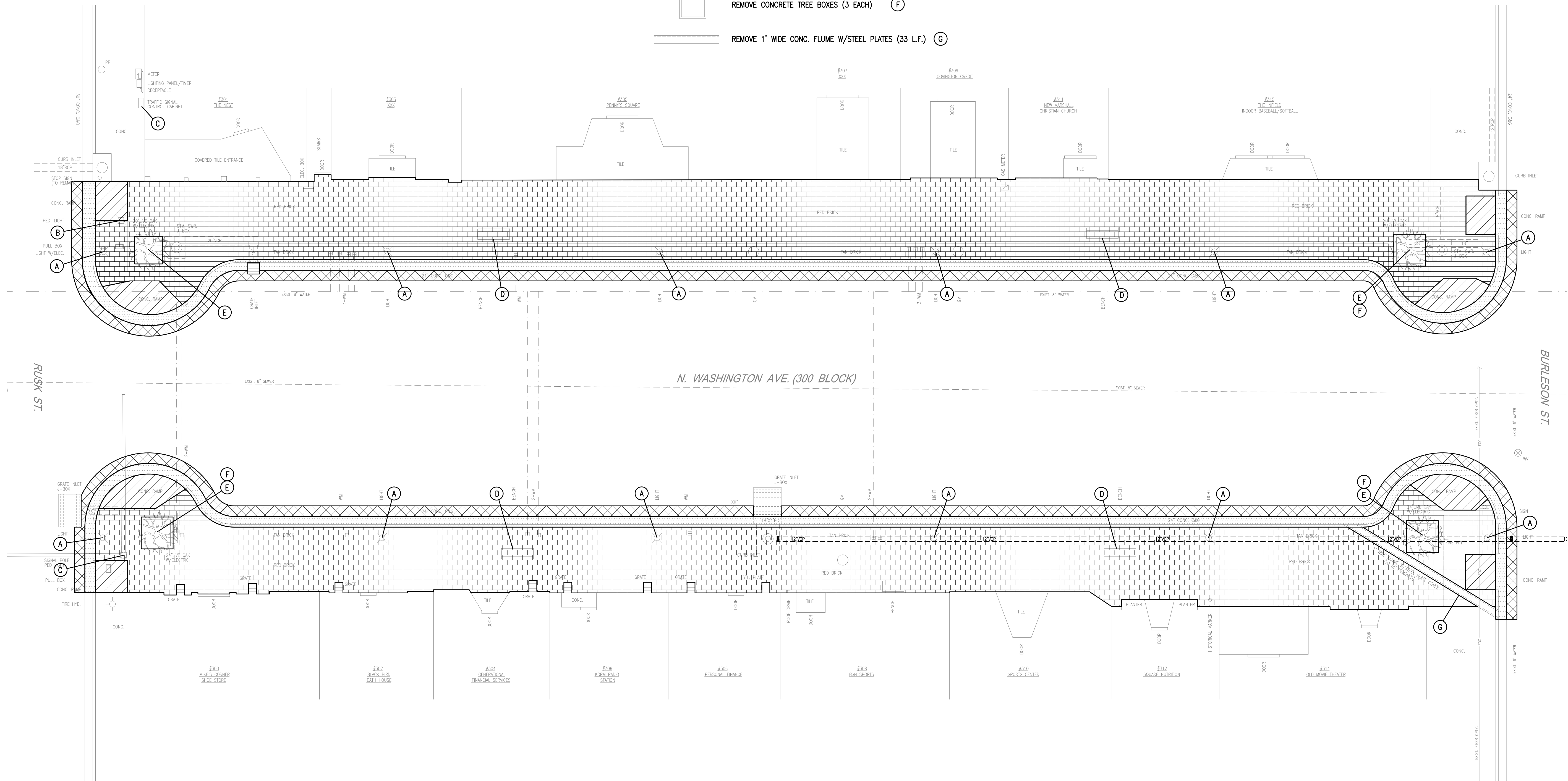

DEMOLITION
PLAN - 300 BLOCK

CITY OF MARSHALL, TX.
DOWNTOWN REDEVELOPMENT PHASE III
300 & 400 BLOCK OF N. WASHINGTON AVENUE

HAYES ENGINEERING, INC.
Texas Registered Engineering Firm F-1465
2126 Alpine St. Longview, TX 75601-3401
Tel.: (903) 758-2010 • Fax: (903) 758-2099

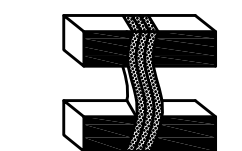

DRAWN BY : R.L.C.
CHECKED BY : S.R.H.
DATE : SEPT. 2023
SCALE : 1"=10'
JOB NO. : MA-21-01
MA-22-04

SHEET

5

OF 27 SHEETS

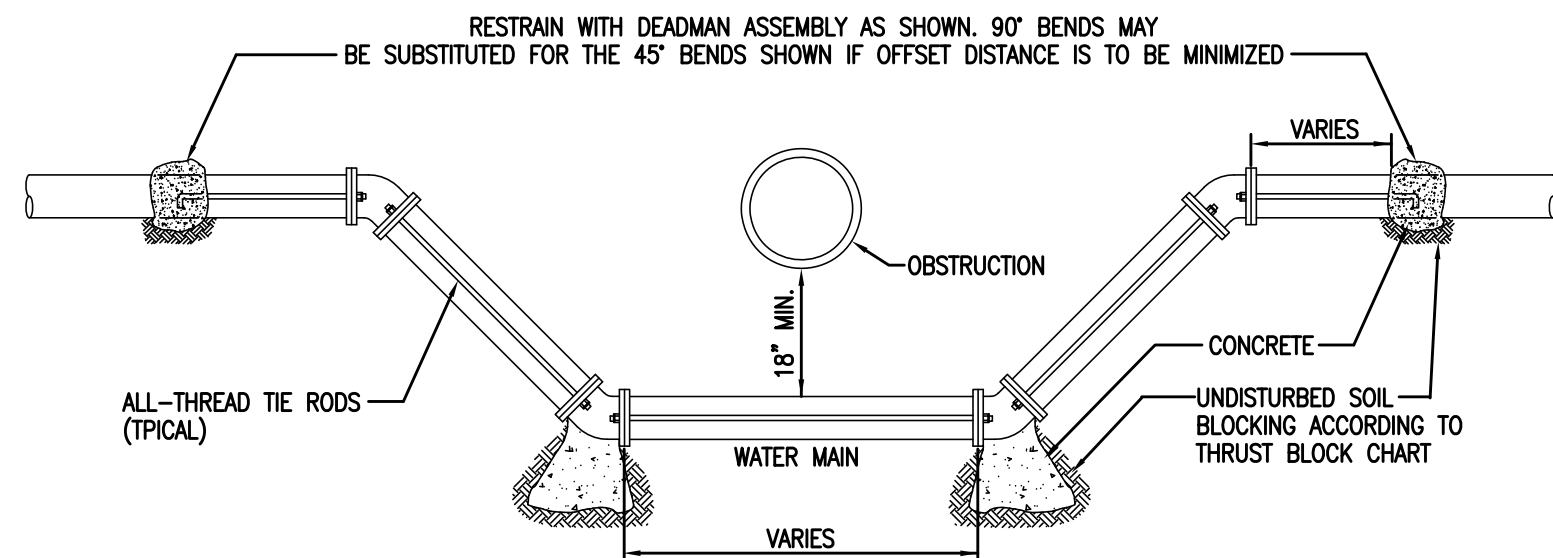
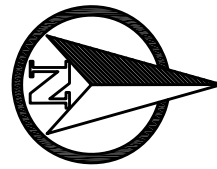

THRUST BLOCK BEARING AREA IN SQUARE FEET					
PIPE SIZE	PLUG OR 90° BEND	45° BEND	22-1/2° BEND	TEE	MINIMUM COUNT OF BLOCKS
6"	3	2	1.5	3	
8"	5	2.5	2	4	
10"	7	4	3	5	
12"	10	6	5	7	
16"	14	8	7	10	
18"	18	12	9	14	

TYPICAL OFFSET - 6" WATER MAIN AND LARGER
(IF REQUIRED)
PROVIDE NECESSARY ASPH. PVMT. REPAIR (PER DETAIL) AT NO DIRECT PAY.

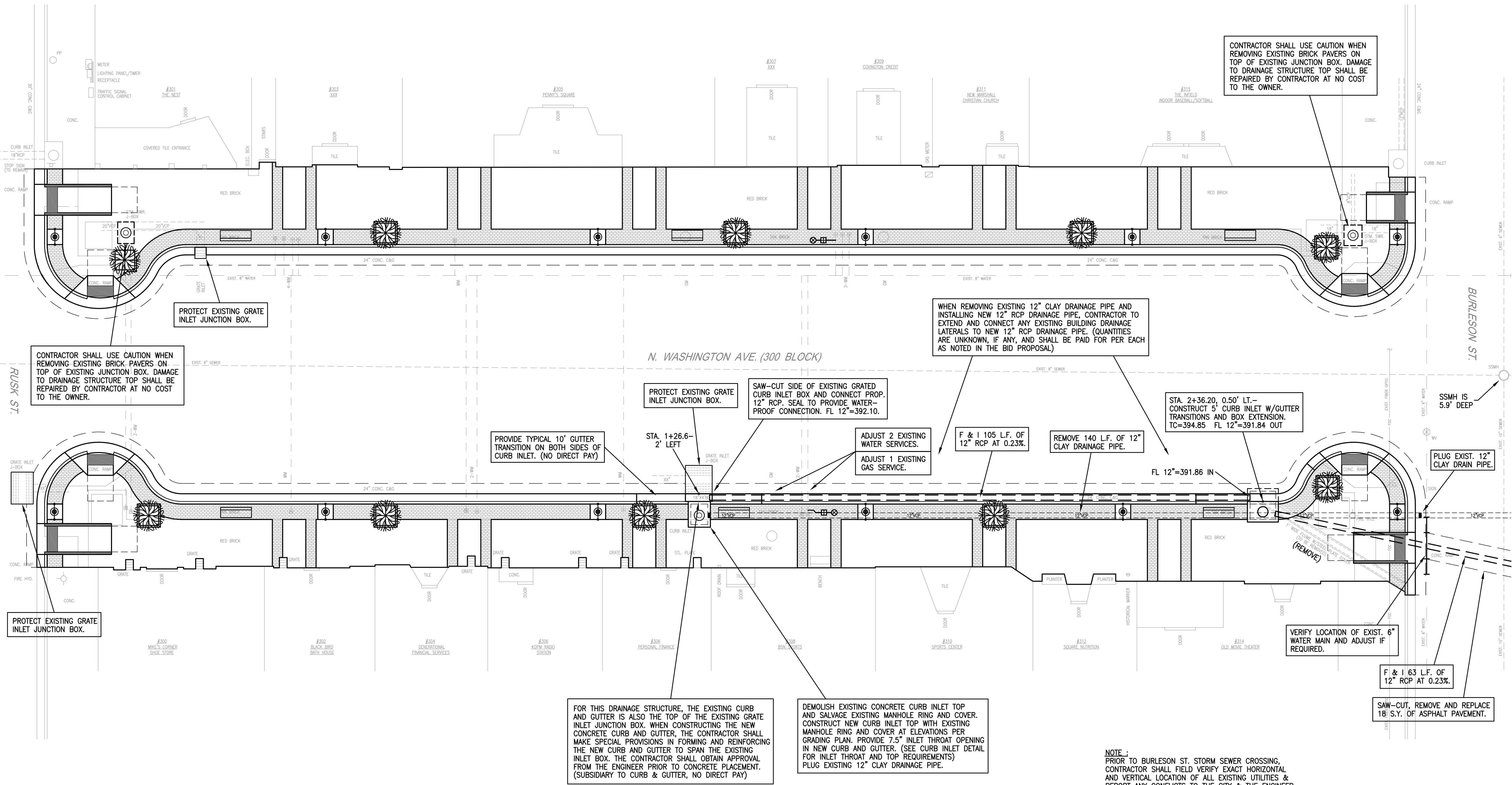

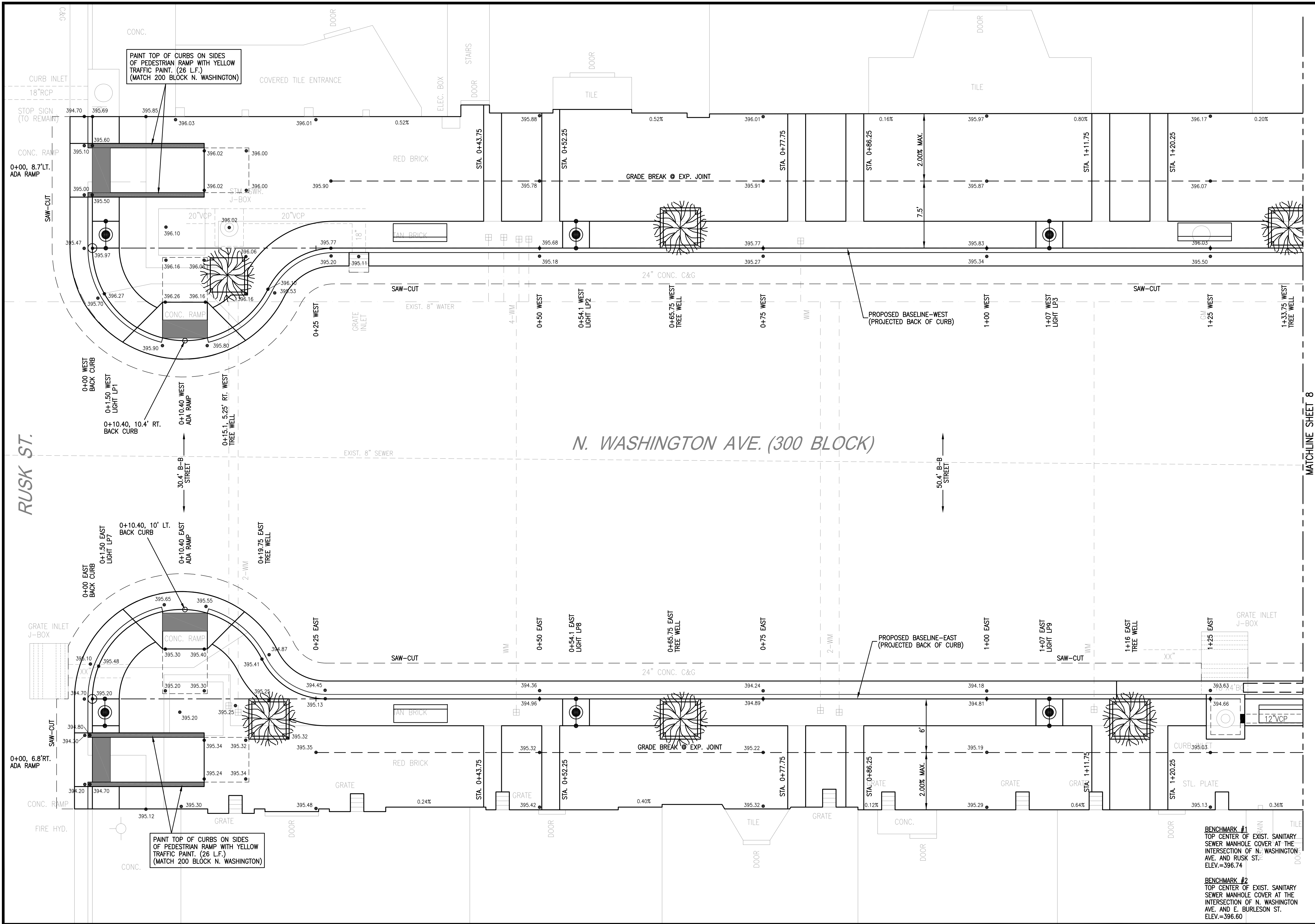

PROPOSED LAYOUT
& GRADING PLAN-
300 BLOCK

CITY OF MARSHALL, TX.
DOWNTOWN REDEVELOPMENT PHASE III
300 & 400 BLOCK OF N. WASHINGTON AVENUE

HAYES ENGINEERING, INC.
Texas Registered Engineering Firm F-1465
2126 Alpine St. Longview, TX 75601-3401
Tel.: (903) 758-2010 • Fax: (903) 758-2099

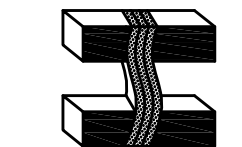

DRAWN BY : R.L.C.
CHECKED BY : S.R.H.
DATE : SEPT. 2023
SCALE : 1"=5'
JOB NO. : MA-21-01
MA-22-04

SHEET
7
OF 27 SHEETS

BENCHMARK #1
TOP CENTER OF EXIST. SANITARY
SEWER MANHOLE COVER AT THE
INTERSECTION OF N. WASHINGTON
AVE. AND RUSK ST.
ELEV.=396.74

BENCHMARK #2
TOP CENTER OF EXIST. SANITARY
SEWER MANHOLE COVER AT THE
INTERSECTION OF N. WASHINGTON
AVE. AND E. BURLISON ST.
ELEV.=396.60

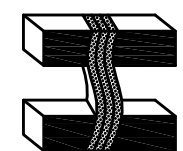

DRAWN BY : R.L.C.
CHECKED BY : S.R.H.
DATE : SEPT. 2023
SCALE : 1"=10'
JOB NO. : MA-21-01
MA-22-04

SHEET

9

OF 27 SHEETS

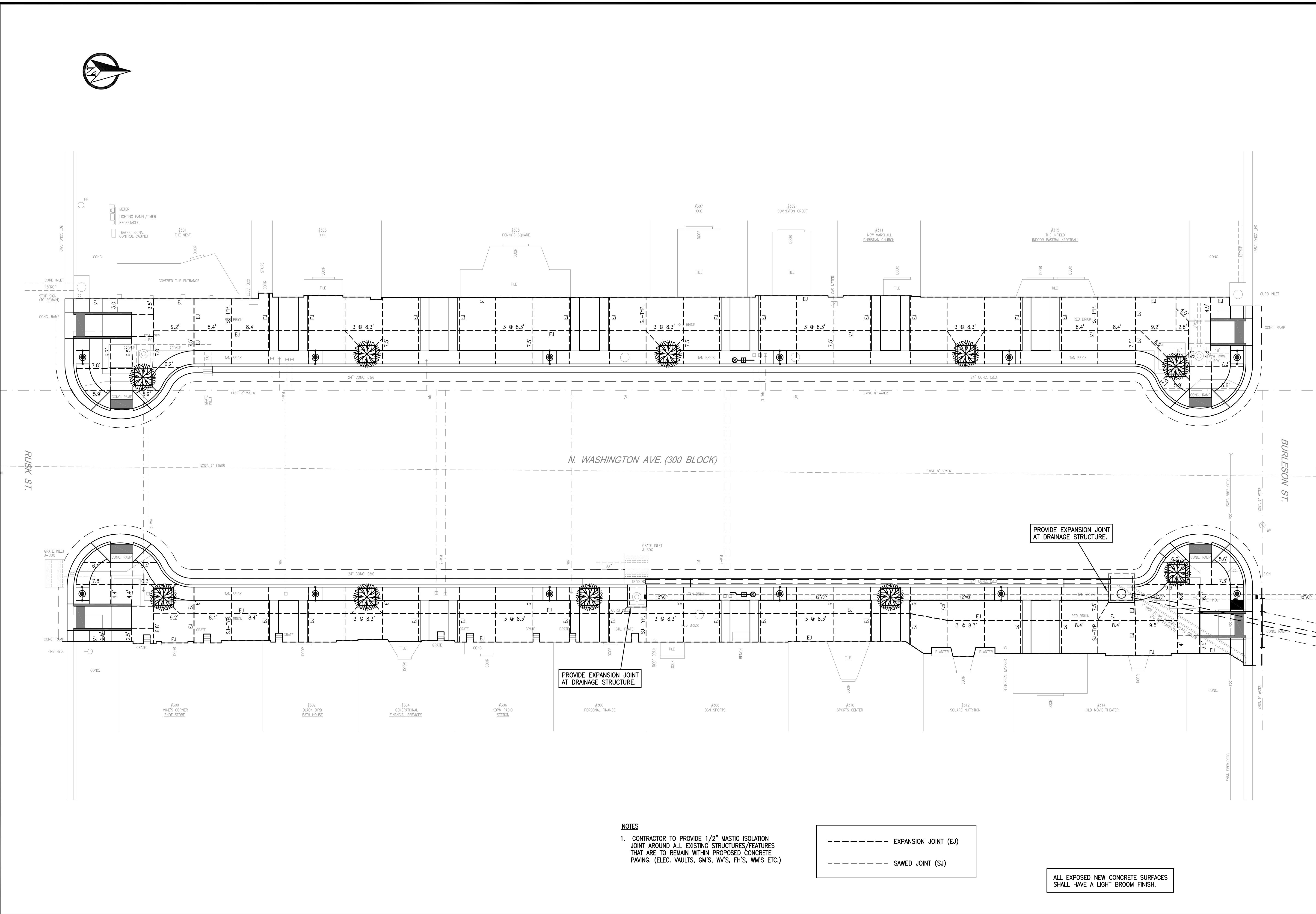

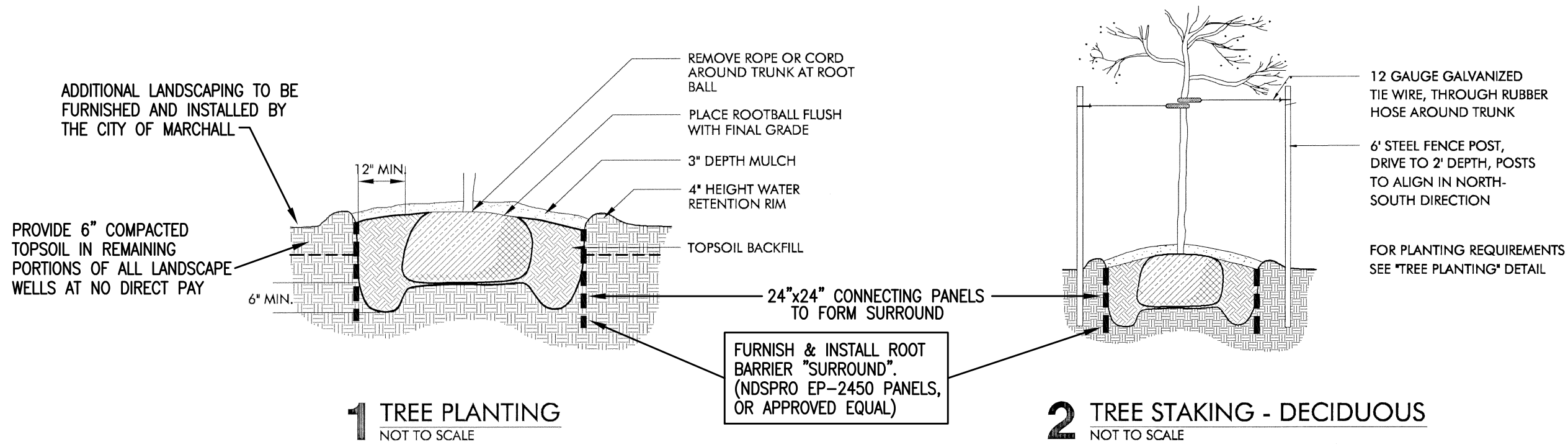

PLANT LEGEND

Qty.	Botanical Name	Common Name	Root Ball	Size	Remarks
TREES					
10	Cercis canadensis "Merlot"	Merlot Redbud	B & B	3"-4" Cp minimum	Matched

Cp = Caliper, Ht = Height, Sp = Spread

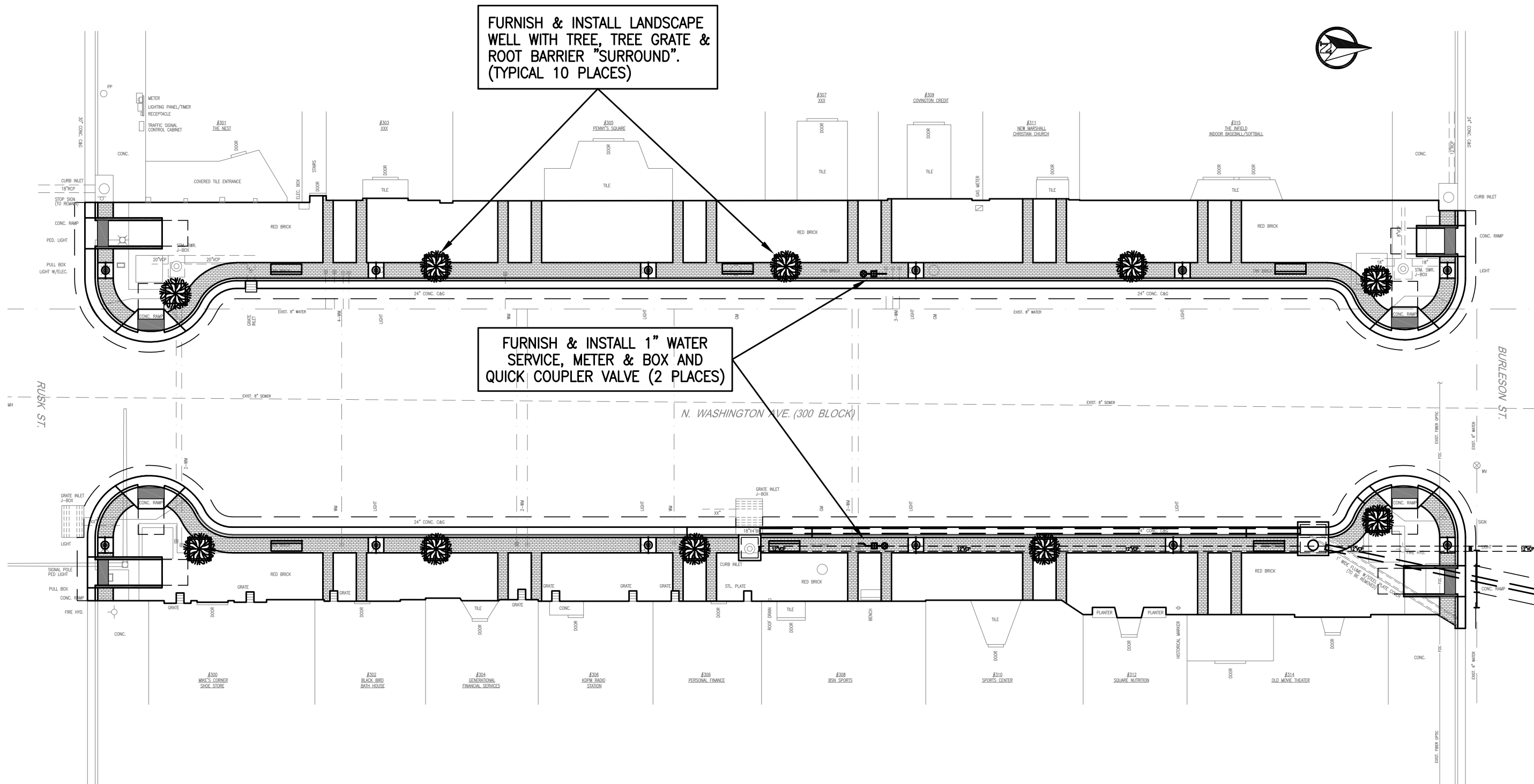

PLANTING NOTES

- THIS SITE HAS A TREMENDOUS AMOUNT OF SUBTERRANEAN UTILITIES AND PIPELINES. SOME OF THESE HAVE BEEN LOCATED ON THE SURVEY AND ARE REFLECTED IN THESE DRAWINGS. IT IS THE CONTRACTOR'S RESPONSIBILITY, HOWEVER, TO HAVE ALL UTILITIES AND PIPELINES LOCATED BEFORE INSTALLING LANDSCAPE MATERIALS. IF THERE ARE CONFLICTS THE ENGINEER SHALL BE CONTACTED IMMEDIATELY.
- CONTRACTOR SHALL VERIFY ALL LANDSCAPE MATERIAL QUANTITIES AND SHALL REPORT ANY DISCREPANCIES TO THE ENGINEER PRIOR TO INSTALLATION.
- CONTRACTOR SHALL MAKE NO SUBSTITUTIONS WITHOUT THE APPROVAL OF THE ENGINEER.
- CONTRACTOR SHALL STAKE LAYOUT PLAN IN THE FIELD AND SHALL HAVE THE LAYOUT APPROVED BY THE ENGINEER BEFORE PROCEEDING WITH THE INSTALLATION.
- ALL LANDSCAPE AREAS SHALL BE MULCHED WITH 3" OF SHREDDED HARDWOOD MULCH. MUCH TO BE APPROVED BY ENGINEER PRIOR TO PLACEMENT. ALL MULCH TO BE RAKED EVEN TO THE SPECIFIED DEPTH & WATER SETTLED. THIS WORK SHALL BE SUBSIDIARY TO LANDSCAPE WORK.
- CONTRACTOR SHALL GUARANTEE ALL WORK AND PLANT MATERIAL FOR PERIOD STATED IN SPECIFICATIONS.
- ANY PLANT MATERIAL WHICH DIES DURING THE GUARANTEE PERIOD SHALL BE REMOVED IMMEDIATELY AND REPLACED BY THE CONTRACTOR DURING THE NEXT NORMAL PLANTING SEASON IN ACCORDANCE WITH THE SPECIFICATIONS AND LOCAL PRACTICE.
- CONTRACTOR SHALL BE RESPONSIBLE FOR MAINTENANCE OF THE PLANTS. SEE SPECIFICATIONS FOR MAINTENANCE PERIOD.
- ALL PLANT NAMES ON THE PLANT LIST SHALL CONFORM TO HORTICULTURAL NOMENCLATURE AS SET FORTH IN HORTUS III OR IN DATASCAPE, 1994 EDITION AND ALL SUPPLEMENTS.
- ALL PLANT MATERIAL SHALL MEET THE MINIMUM SPECIFICATIONS IN THE "AMERICAN STANDARD FOR NURSERY STOCK" (ANSI Z60.1-1990 OR LATEST REVISION) SPONSORED BY THE AMERICAN ASSOCIATION OF NURSERYMEN, AND BE FREE OF PLANT DISEASES AND PEST. THE PLANTS SHALL BE OF TYPICAL FORM FOR THE SPECIES AND HAVING A HEALTHY, WELL BRANCHED ROOT SYSTEM.
- SIZES INDICATED ON THE PLANT LIST ARE THE MINIMUM ACCEPTABLE SIZE. IN NO CASE WILL SIZES LESS THAN THE SPECIFIED SIZES BE ACCEPTED.
- PLANTS SHALL BE PRUNED ONLY IN ACCORDANCE WITH STANDARD SPECIFICATIONS.
- THE CONTRACTOR SHALL BE RESPONSIBLE FOR ANY COORDINATION WITH OTHER RELATED SITE WORK BEING PERFORMED BY OTHER CONTRACTORS AS REQUIRED TO ACCOMPLISH SITE CONSTRUCTION OPERATIONS.
- THE PLANTING OF ANY PLANT MATERIAL WILL INCLUDE AS SUBSIDIARY ITEMS: MULCH, STAKES AND ANY OTHER ELEMENTS NECESSARY TO INSTALL AS DETAILED.
- THE CONTRACTOR SHALL BE RESPONSIBLE FOR INSURING THE TREE PITS ARE EXCAVATED TO TWICE THE ROOT BALL SIZE.

PROPOSED
LANDSCAPING-
300 BLOCK

CITY OF MARSHALL, TX.
DOWNTOWN REDEVELOPMENT PHASE III
300 & 400 BLOCK OF N. WASHINGTON AVENUE

HAYES ENGINEERING, INC.
Texas Registered Engineering Firm F-4465
2126 Alpha St. Longview, TX 75601-3401
Tel.: (903) 758-2010 • Fax: (903) 758-2099

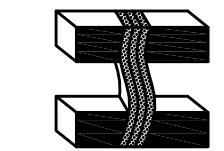

DRAWN BY : R.L.C.
CHECKED BY : S.R.H.
DATE : SEPT. 2023
SCALE : 1"=20'
JOB NO. : MA-21-01
MA-22-04

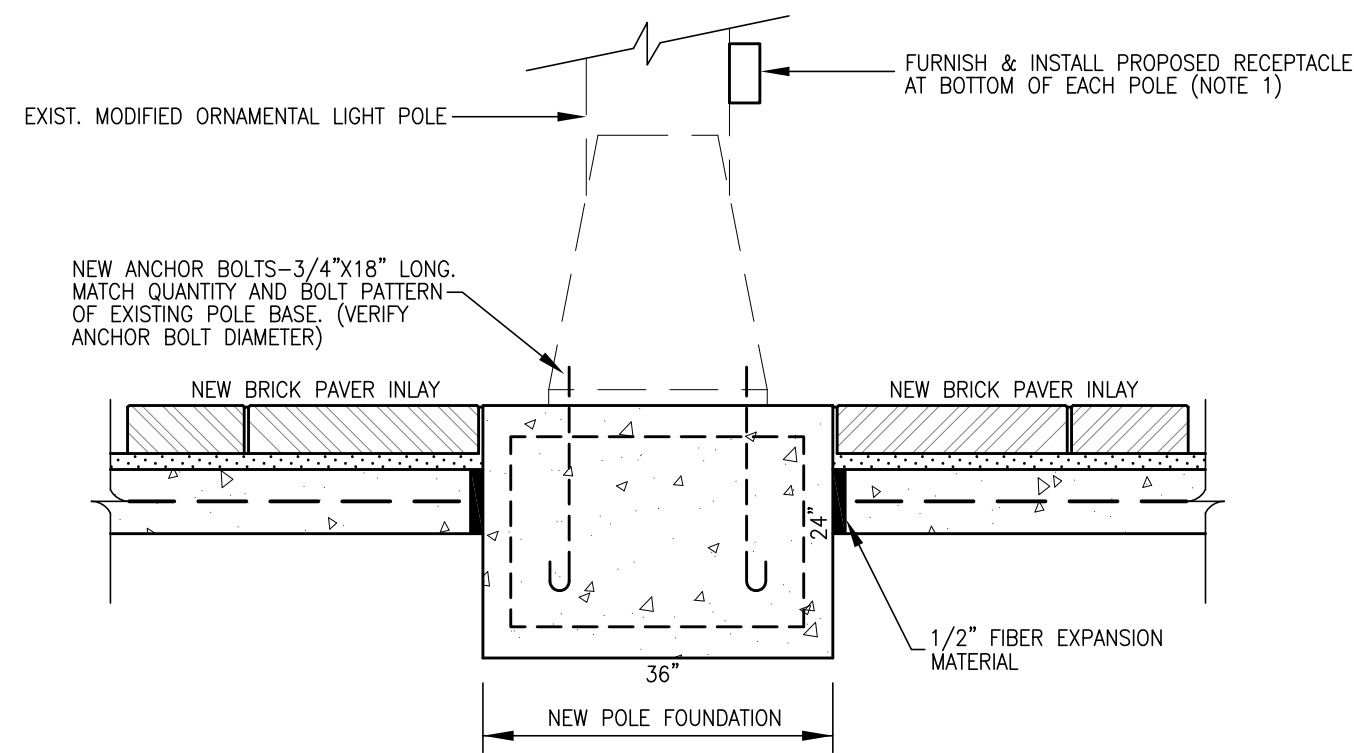

EXISTING LIGHT POLE-NEW FOUNDATION DETAIL

N.T.S.

- 1) FURNISH AND INSTALL ADDITIONAL RECEPTACLE AT TOP OF EACH POLE.

ORNAMENTAL STREET LIGHT POLE/FIXTURE MODIFICATIONS

1. EXISTING ORNAMENTAL LIGHT POLES SHALL BE REMOVED, MODIFIED AND RE-USED.
2. CONTRACTOR SHALL REMOVE EXISTING LIGHT FIXTURES & DELIVER TO THE CITY.
3. CONTRACTOR SHALL DELIVER LIGHT POLES TO BRYCE GISSSELBECK AT "WELDING AND MACHINE WORKS" (903)263-9361 FOR MODIFICATIONS. MODIFICATIONS INCLUDE DRILLING AND TAPPING ONE 1/2" NPT HOLE AT THE TOP AND BOTTOM OF EACH POLE FOR THE ADDITION OF TWO ELECTRICAL RECEPTACLES THAT SHALL BE FURNISHED AND INSTALLED BY THE CONTRACTOR. EACH RECEPTACLE SHALL BE A 20A, 120V, GFCI, DUPLEX IN A FD BOX WITH A WPIU COVER PLATE. PAINT TO MATCH POLE. ADDITIONAL REPAIRS TO EXISTING POLES SHALL ALSO BE PERFORMED AS NECESSARY.
4. EXISTING MODIFIED LIGHT POLES SHALL BE RE-INSTALLED. PROPOSED FOUNDATIONS, CONDUITS AND WIRING SHALL ALSO BE INSTALLED AS SHOWN IN THE PLANS.
5. (12) NEW LIGHT FIXTURES SHALL BE FURNISHED BY THE CITY FOR INSTALLATION BY THE CONTRACTOR.
6. POLES/FIXTURES SHALL BE HANDLED WITH CARE TO PREVENT DAMAGE.

CONTRACTOR SHALL CONSTRUCT POLE FOUNDATION FOR EACH LIGHT FIXTURE. FOUNDATION TO BE 3'X3'X24" THICK, 3000 PSI CONCRETE WITH #4'S AT ABOUT 9" O.C.E.W. AROUND PERIMETER AND TOP AND BOTTOM. FOUNDATION TO BE LEVEL.

- UR - UPPER RECEPTACLE
LR - LOWER RECEPTACLE
- 1 - COORDINATE WITH OWNER AND UTILITY. DISCONNECT POWER. REMOVE ALL TRAFFIC SIGNAL ITEMS. PROVIDE NEW LIGHTING CONTROL PANEL. SERVICE RISER CONDUIT, WIRING, METER & ELECTRICAL RACK SHALL BE REPLACED. F&I NEW CONDUIT & WIRING AS NOTED. SAW CUT AND PROVIDE PAVEMENT REPAIR.
 - 2 - 2" (EMPTY)
 - 3 - DISCONNECT & REMOVE EXIST. OVERHEAD AND UNDERGROUND SERVICE TO EXIST. ORNAMENTAL LIGHT POLE.
 - 4 - 2" W/(4)-#10 (LTC), (4)-#8 (LR), (4)-#8 (LR) & (1)-#6 EGC
 - 5 - 2" W/(2)-#10 (LTC), (2)-#8 (LR), (2)-#8 (LR) & (1)-#6 EGC
 - 6 - 3/4" X 30' COPPERCLAD STEEL GROUND ROD
 - 7 - 18" X 24" PULL BOX
 - 8 - COORDINATE WITH OWNER AND UTILITY. DISCONNECT POWER. REPLACE EXIST. SERVICE & METER. PROVIDE NEW LIGHTING CONTROL PANEL NEAR CORNER OF BUILDING. MOUNT ON GALVANIZED UNISTRUT AT FACE OF BUILDING. FURNISH & INSTALL NEW GROUND. SAW CUT AND PROVIDE PAVEMENT REPAIR.
 - 9 - F & I DUPLEX RECEPTACLE IN WEATHERPROOF BOX
 - 10 - STUB-OUT 10±" AND CAP TWO 2" (EMPTY) FOR FUTURE EXTENSION.

ELECTRICAL NOTES:

1. ALL ELECTRICAL IMPROVEMENTS SHALL BE IN COMPLIANCE WITH NEC AND CITY OF MARSHALL BUILDING CODES.
2. CONTRACTOR SHALL VERIFY LOCATION OF EXISTING CIRCUITS. COORDINATE WITH OWNER AND UTILITY.
3. PRIOR TO EXISTING LIGHTING CONDUIT REMOVAL, THE CITY OF MARSHALL SHALL INSPECT THE CONDUIT FOR THE POSSIBILITY OF RE-USING IN PLACE WITH NEW WIRING.
4. ALL ORNAMENTAL LIGHTING CONTROLS SHALL HAVE, AT A MINIMUM, SERVICE, METER, NEW LIGHTING PANEL, DUPLEX RECEPTACLE IN WEATHERPROOF BOX AND GROUNDING.

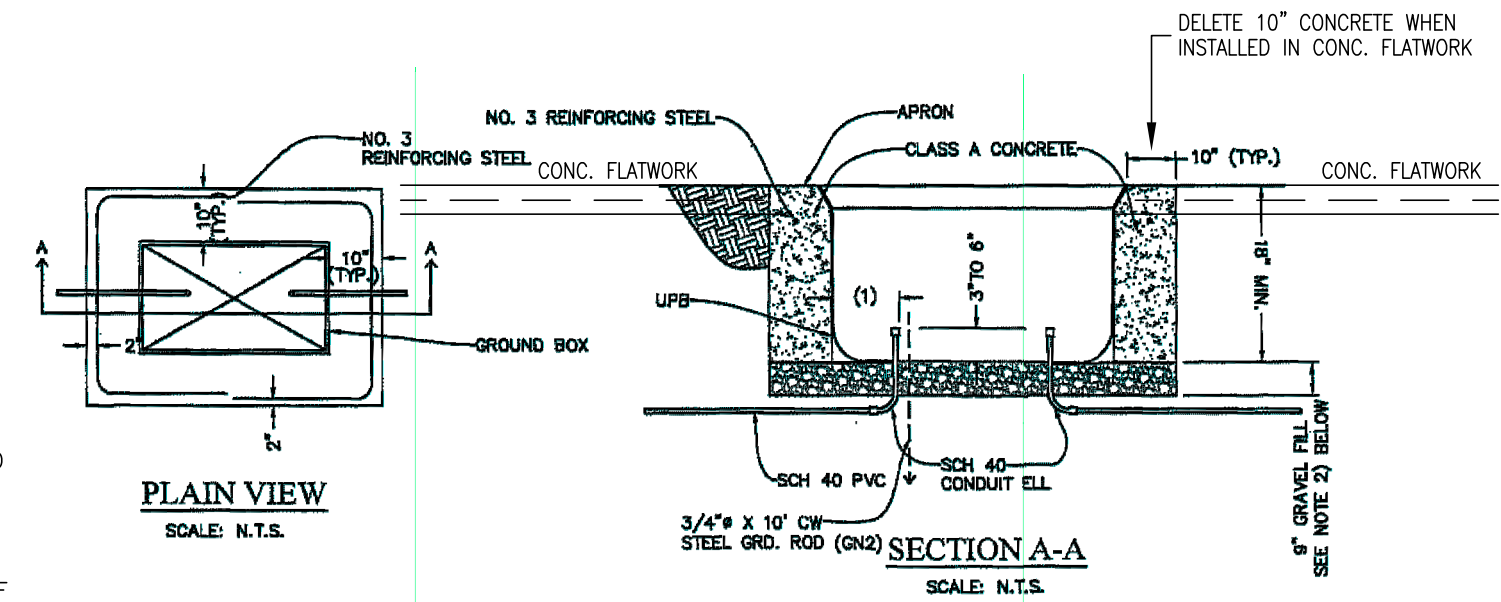

APRON FOR UNDERGROUND PULL BOX (UPB)

SCALE: N.T.S.

- 1) FINAL POSITION OF END OF CONDUIT SHALL NOT EXCEED ONE - HALF THE DISTANCE TO THE SIDE OF BOX OPPOSITE THE CONDUIT ENTRY.
- 2) PLACE GRAVEL "UNDER" THE BOX AND NOT "IN" THE BOX. GRAVEL SHALL NOT ENCRUSH ON THE INTERIOR VOLUME OF THE BOX.
- 3) INSTALL BUSHING ON THE UPPER END OF ALL CONDUIT ELBOWS.
- 4) WHERE A GROUND ROD IS PRESENT IN THE GROUND BOX, CONNECT IT TO ANY AND ALL EQUIPMENT GROUNDING CONDUCTORS BY EXOTHERMIC WELD PROCESSES.
- 5) MAINTAIN SUFFICIENT SPACE BETWEEN ALL CONDUITS SO AS TO ALLOW FOR PROPER INSTALLATION OF BUSHINGS.
- 6) ALL CONDUITS SHALL BE INSTALLED IN A NEAT AND WORKMAN LIKE MANNER.
- 7) ALL CONDUITS INSTALLED IN THE GROUND BOX SHALL BE SEALED USING DUXSEAL (OR EQUIVALENT) AFTER COMPLETION OF CONDUITOR INSTALLATION AND ANY REQUIRED PULL TESTS.
- 8) UPB SHALL BE AS MANUFACTURED BY ARMORCAST, OLD CASTLE PRECAST, OR EQUIVALENT.

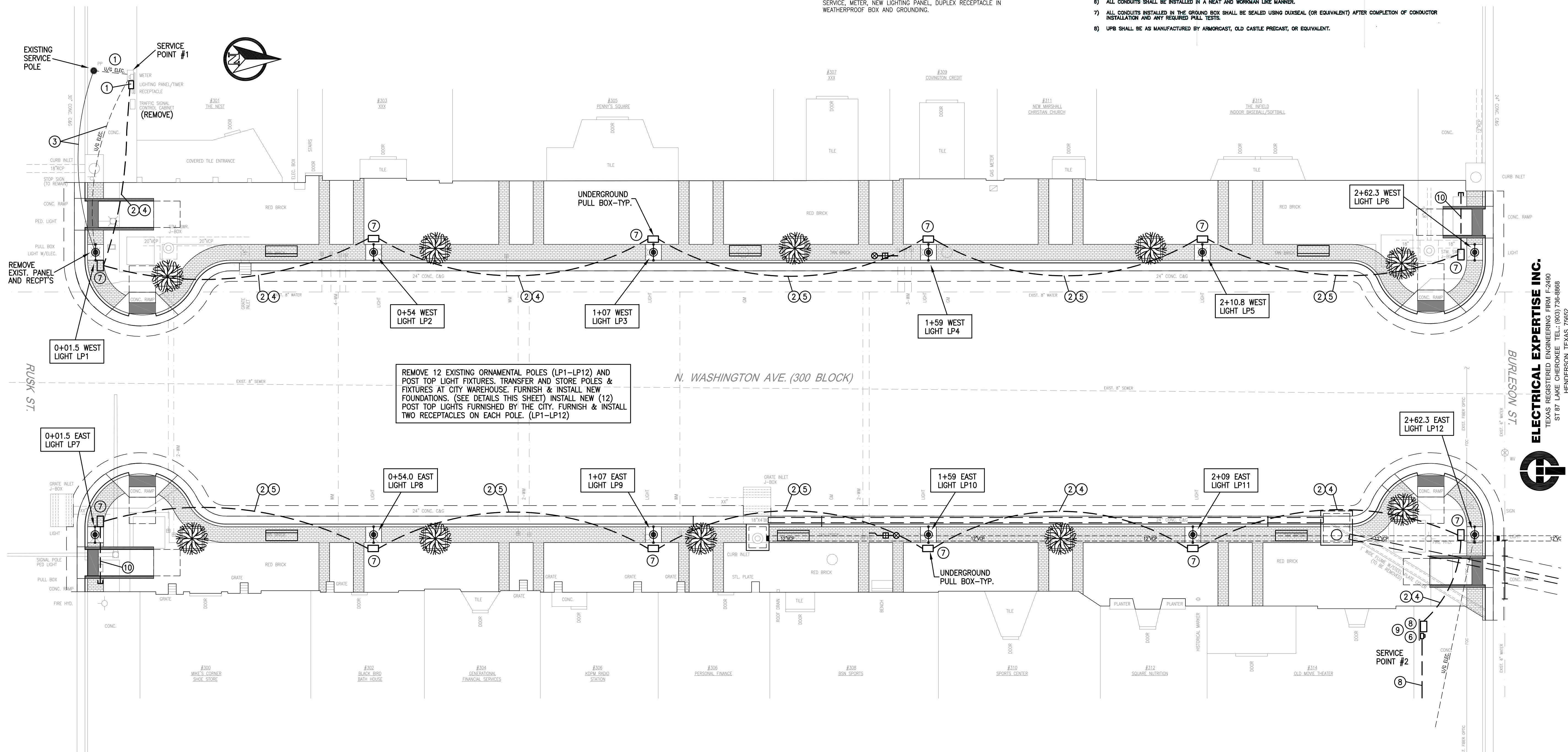

PROPOSED LIGHTING PLAN- 300 BLOCK

CITY OF MARSHALL, TX. DOWNTOWN REDEVELOPMENT PHASE III 300 & 400 BLOCK OF N. WASHINGTON AVENUE

ELECTRICAL EXPERTISE INC.

TEXAS REGISTERED ENGINEERING FIRM F-2490
ST 87 LAKE CHEROKEE TEL: (903) 736-8868
HENDERSON, TEXAS 75652



HAYES ENGINEERING, INC.

Texas Registered Engineering Firm F-1465
2126 Alpine St. Longview, TX 75601-3401
Tel.: (903) 758-2010 • Fax: (903) 758-2099

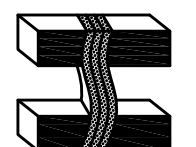

DRAWN BY: R.L.C.
CHECKED BY: W.W.J.
DATE: SEPT. 2023
SCALE: 1"=10'
JOB NO.: MA-21-01
MA-22-04

SHEET

11

OF 27 SHEETS

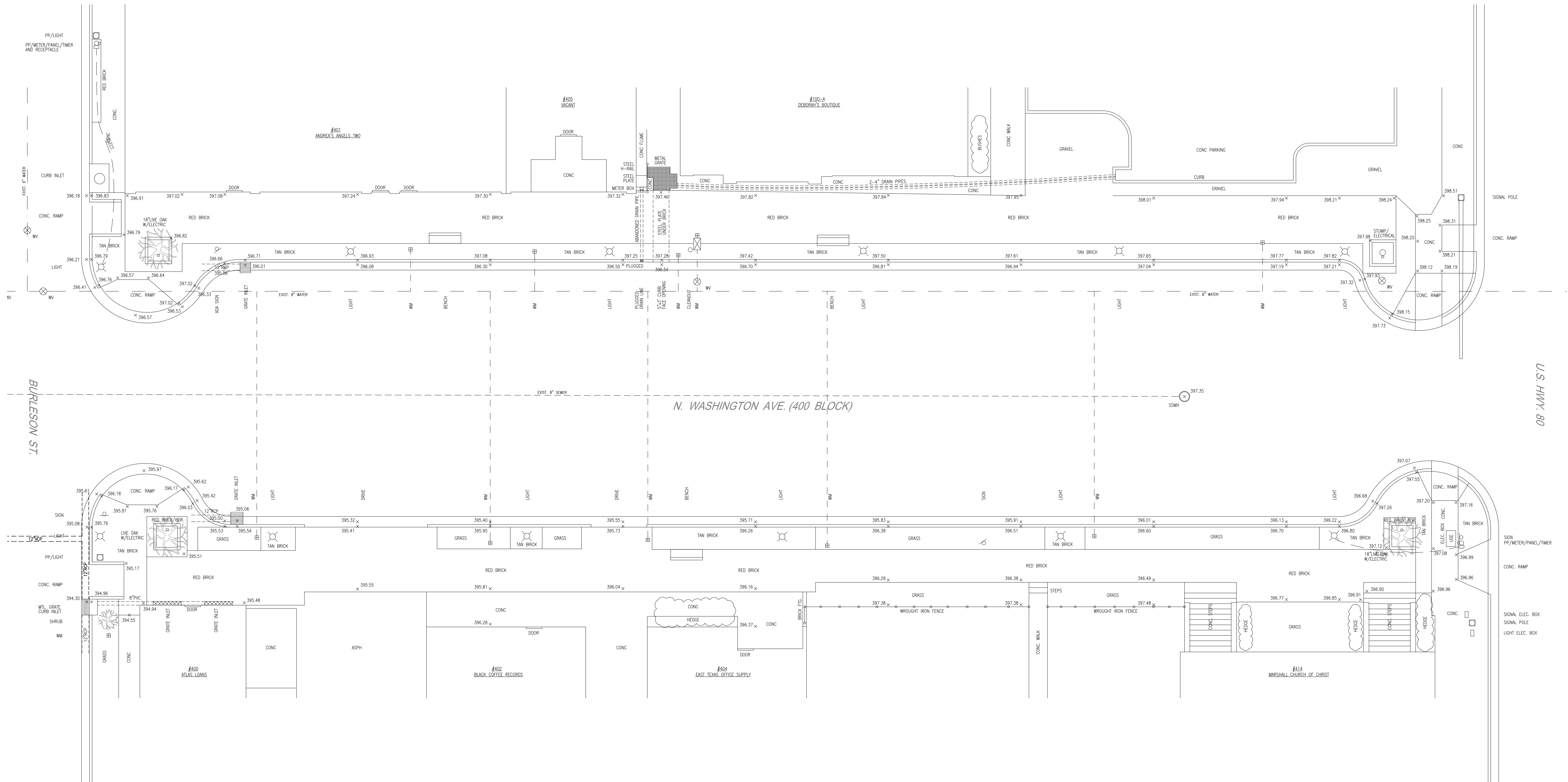
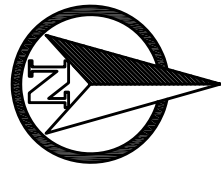

EXISTING SITE
PLAN - 400 BLOCK

CITY OF MARSHALL, TX.
DOWNTOWN REDEVELOPMENT PHASE III
300 & 400 BLOCK OF N. WASHINGTON AVENUE

HAYES ENGINEERING, INC.
Texas Registered Engineering Firm F-1465
2126 Alpine St. Longview, TX 75601-3401
Tel.: (903) 758-2010 • Fax: (903) 758-2099

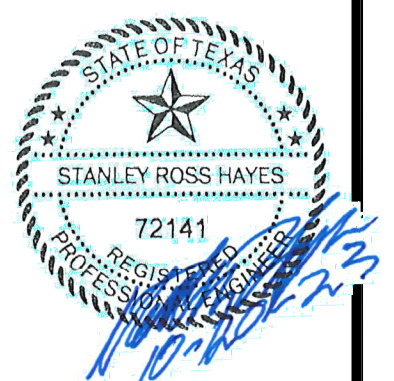

DRAWN BY : R.L.C.
CHECKED BY : S.R.H.
DATE : SEPT. 2023
SCALE : 1"=10'
JOB NO. : MA-21-01
MA-22-04

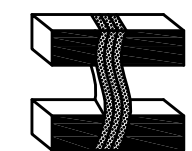

DRAWN BY : R.L.C.
CHECKED BY : S.R.H.
DATE : SEPT. 2023
SCALE : 1"=10'
JOB NO. : MA-21-01
MA-22-04

SHEET

13

OF 27 SHEETS

PROPOSED IMPROVEMENTS (ILLUSTRATIVE)

(REFER TO "BID PROPOSAL" IN SPECIFICATIONS FOR ACTUAL BID/PAYMENT ITEMS)

- 1 SALVAGE EXIST. SIGN & PLACE ON NEW POST AND MOUNT PER DETAIL. (2 EA.)
- 2 PROPOSED EXIST. MODIFIED ORNAMENTAL STREET LIGHT (12 EACH) WITH NEW FOUNDATION.
- 3 PROPOSED NEW CONCRETE FLATWORK, INCLUDING UNDER BRICK INLAY. (6,105 S.F.)
- 4 PROPOSED NEW BRICK PAVER INLAY ON SAND CUSHION. (1,675 S.F.)
- 5 PROPOSED PEDESTRIAN CURB RAMP RECONSTRUCTION. (TYPE 1) (4 EACH) (ASSOCIATED 24" CURB & GUTTER AND 5'x5' LANDING TO BE INCLUDED IN BID PRICE)
- 6 PROPOSED NEW LANDSCAPE WELL WITH TREE GRATE. (10 EACH)
- 7 PROPOSED NEW BENCH, TRASH RECEPTACLE OR PLANTER. (6 EACH)
- 8 PROPOSED NEW 24" CONCRETE CURB AND GUTTER. INCLUDES LAYDOWN (489 L.F.)
- 9 PROPOSED NEW TREE WITH ROOT BARRIER "SURROUND" (10 EACH)
- 10 PROPOSED STOP/ONE WAY SIGN (2 EA.)
- 11 PROPOSED WATER SERVICE, METER & QUICK COUPLER VALVE (2 EACH)
- 12 PROPOSED ASPHALT PATCH INCLUDING SAW CUTS-2' WIDE (124 S.Y.)
- 13 PROPOSED 8" WIDE WHITE CROSSWALK STRIPING-6" INSIDE/INSIDE (55 L.F.) (TXDOT ITEM 666, TYPE II). OBLITERATE EXISTING 4" CROSSWALK STRIPING.
- 14 PROPOSED 12" RCP STORM SEWER (82 L.F.)
- 15 CONSTRUCT CURB INLET WITH BOX EXTENSION (1 EA.)
- 16 CONSTRUCT INLET BOX WITH OPENING IN BACK (1 EA.)
- 17 PROPOSED PEDESTRIAN CURB RAMP RECONSTRUCTION. (TYPE 3) (1 EACH) (ASSOCIATED 24" CURB & GUTTER AND 5'x5' LANDING TO BE INCLUDED IN BID PRICE)

NOTES

1. CONTRACTOR SHALL REMOVE & SALVAGE ANY BRICK PAVERS WHICH ARE NOT STUCK TO EXISTING CONCRETE BASE AND PLACE ON A PALLET AND LOADED ONTO A TRAILER PROVIDED BY THE CITY OF MARSHALL. IT IS ANTICIPATED THAT THIS COULD BE A COUPLE OF PALLETS.
2. EXISTING ORNAMENTAL LIGHTS, BENCHES, TRASH CANS, PLANTERS, ETC. BELONGING TO THE CITY OF MARSHALL SHALL BE SALVAGED AND DELIVERED TO A LOCATION SPECIFIED BY THE CITY OF MARSHALL.
3. CONTRACTOR SHALL PROTECT ALL OVERHEAD CANOPIES & AWNINGS.
4. CONTRACTOR SHALL ADJUST ALL UTILITY BOXES/ITEMS TO NEW SIDE-WALK GRADE AS NECESSARY.
5. CONTRACTOR SHALL ASSIST BUSINESS OWNERS IN RELOCATING PRIVATE OWNED ITEMS IN THE LINE OF CONSTRUCTION. (ON-SITE ONLY AT NO DIRECT PAY)
6. CONTRACTOR SHALL REPAIR AND/OR REPLACE EXISTING PAVEMENT MARKINGS REMOVED OR DAMAGED BY CONSTRUCTION ACTIVITIES. USE REFLECTORIZED TRAFFIC PAINT, MATCHING EXISTING COLOR AND WIDTH. (NO DIRECT PAY)

ORNAMENTAL BENCHES, TRASH RECEPTACLES & PLANTERS

MANUFACTURER-DUMOR, INC.
MIFFLINTOWN, PA.
TEL.: 1-800-598-4018
DUMOR.COM
(OR PRIOR APPROVED EQUAL)

BENCHES: 58-60 6' CAST BENCH, STEEL SEAT

TRASH REC.: 102-32SH 32 GAL. STEEL REC. W/SHIELD
& RECYCLED LID, 4" OPENING

PLANTER: 22-00SH STEEL PLANTER W/SHIELD

CONTRACTOR SHALL FURNISH 6 BENCHES, 6 TRASH RECEPTACLES AND 6 PLANTERS. CONTRACTOR SHALL INSTALL THESE ITEMS AT LOCATIONS DETERMINED BY THE CITY OF MARSHALL.

NEW BRICK PAVERS

MANUFACTURER- ACME BRICK
COLOR: PATHWAY RED

ALL NEW BRICK PAVERS INSTALLED SHALL BE UNIFORM IN COLOR AND ACCEPTABLE TO THE CITY OF MARSHALL.

NEW BRICK PAVERS DAMAGED OR CHIPPED DURING PLACEMENT MUST BE REMOVED AND REPLACED.

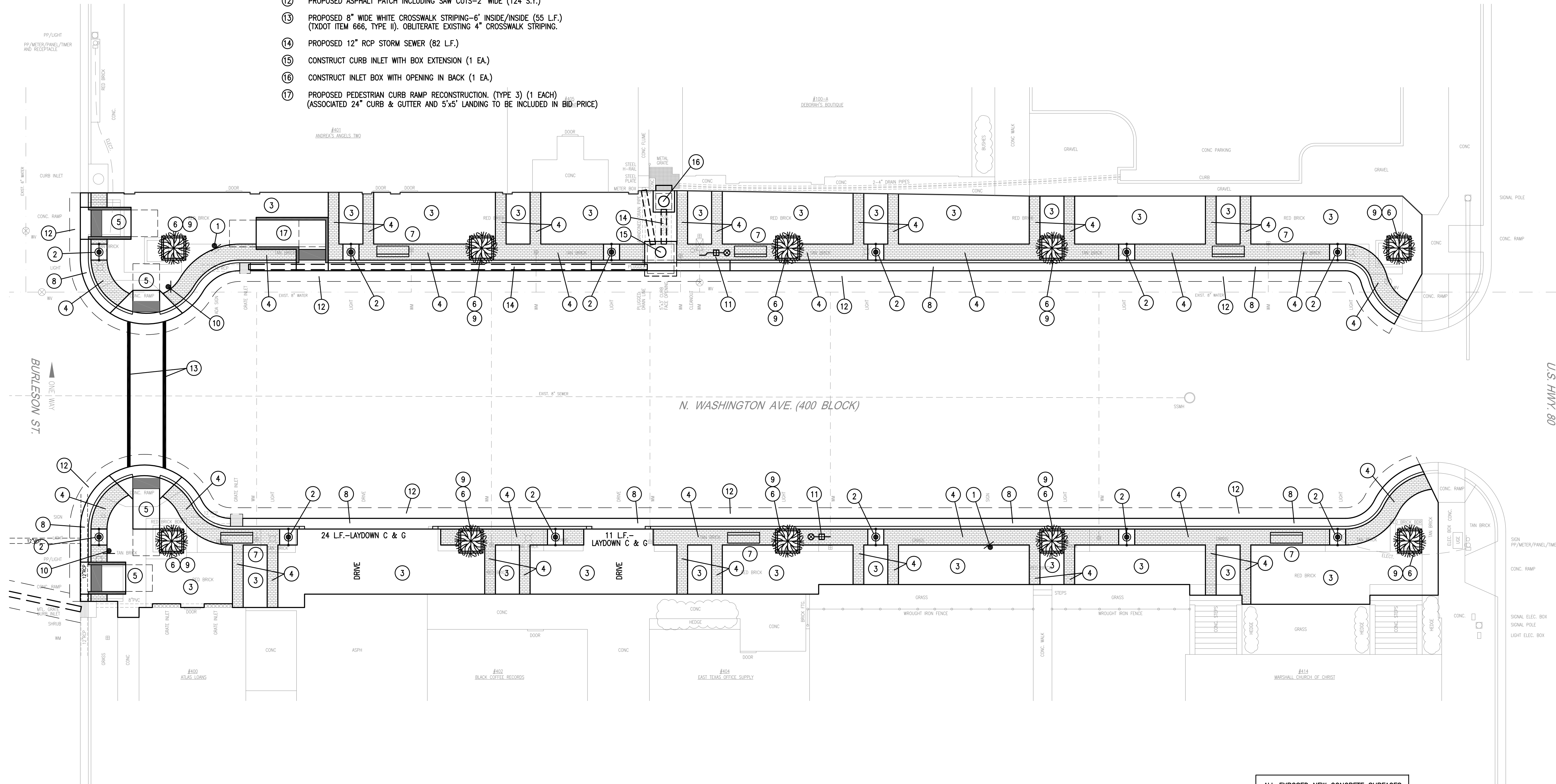

ALL EXPOSED NEW CONCRETE SURFACES
SHALL HAVE A LIGHT BROOM FINISH.

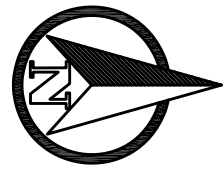

(REFER TO "BID PROPOSAL" IN SPECIFICATIONS FOR ACTUAL BID/PAYMENT ITEMS)

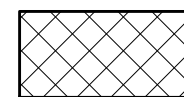

REMOVE AND DISPOSE OF EXISTING ASPHALT PAVING
AND BASE AS REQUIRED (APPROX. 124 S.Y. TOTAL)

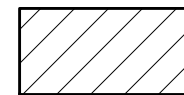

REMOVE AND DISPOSE OF EXISTING CONCRETE ADA RAMP
AND BASE AS REQUIRED (4 EA.)

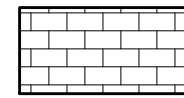

REMOVE EXISTING BRICK SIDEWALK PAVING, INCLUDING
1-5/8" BRICK, 1" GROUT, 4" CONCRETE BASE.
(APPROX. 5,882 S.F. TOTAL)

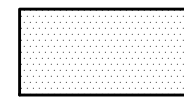

REMOVE AND DISPOSE OF EXISTING CURB & GUTTER
(APPROX. 551 L.F.)



REMOVE EXISTING ORNAMENTAL LIGHT POLE & FOUNDATION (12 EACH) (A)
(ORNAMENTAL LIGHT POLE/FIXTURE TO BE MODIFIED AND
RE-USED ON NEW FOUNDATION-SEE LIGHTING PLAN)



REMOVE EXISTING BENCH (3 EACH) (D)

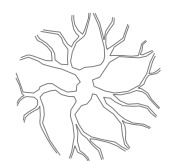

REMOVE TREES AND ELECTRIC (3 EACH) (E)



REMOVE CONCRETE TREE BOXES (4 EACH) (F)

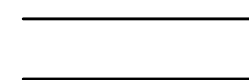

REMOVE 3' WIDE CONC. FLUME W/STEEL PLATES (13 L.F.) (C)

NOTES

- CONTRACTOR SHALL SALVAGE TREE TRUNKS 12 INCH IN DIAMETER AND
LARGER AND PLACE THEM ON A TRAILER PROVIDED BY THE CITY OF MARSHALL.

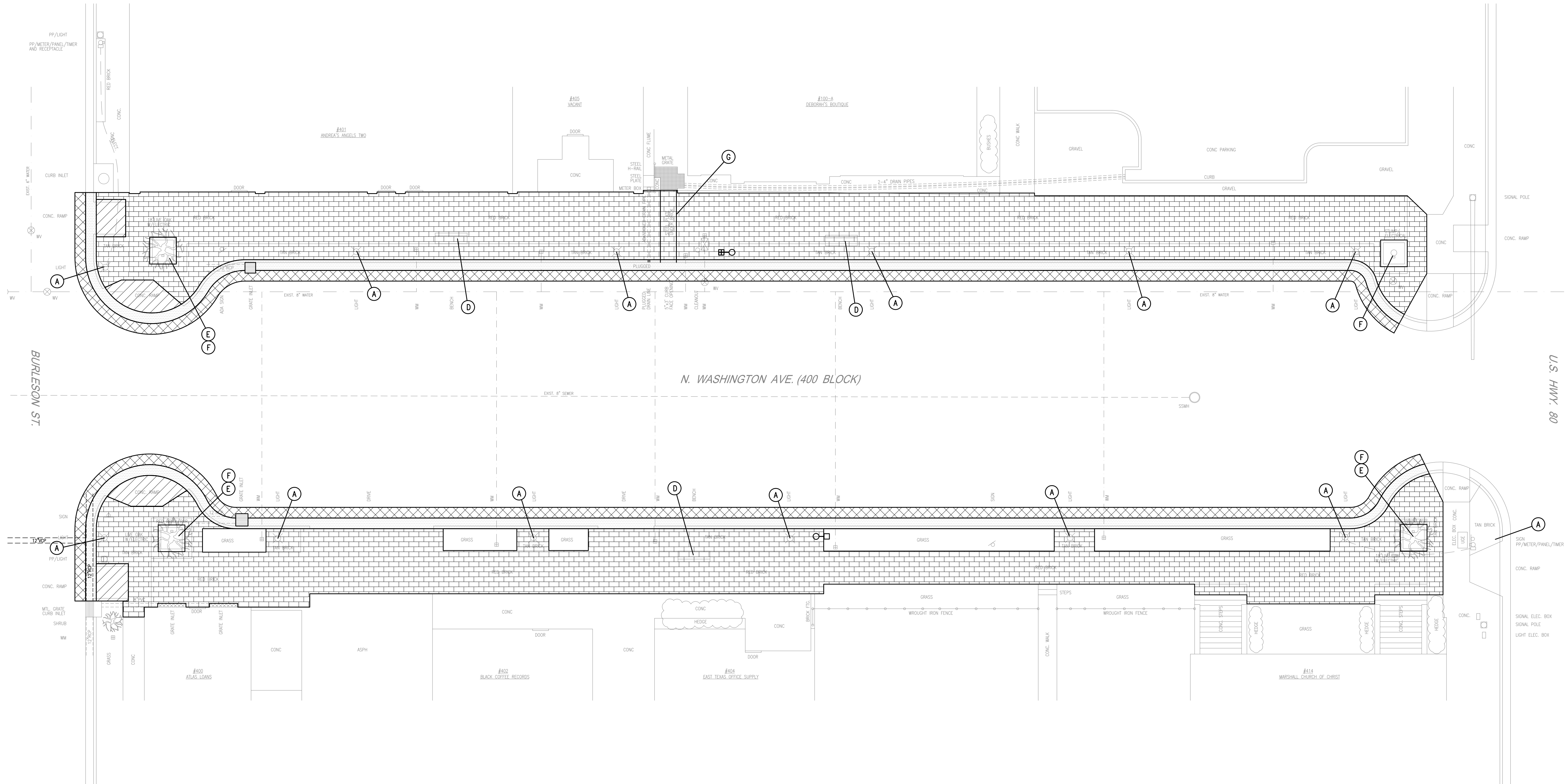

HAYES ENGINEERING, INC.

Texas Registered Engineering Firm F-1465
2126 Alpine St. Longview, TX 75601-3401
Tel.: (903) 758-2010 • Fax: (903) 758-2099

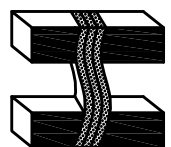

DRAWN BY : R.L.C.
CHECKED BY : S.R.H.
DATE : SEPT. 2023
SCALE : 1"=10'
JOB NO. : MA-21-01
MA-22-04

SHEET

14

OF 27 SHEETS

CITY OF MARSHALL, TX.
DOWNTOWN REDEVELOPMENT PHASE III
300 & 400 BLOCK OF N. WASHINGTON AVENUE

DEMOLITION
PLAN - 400 BLOCK

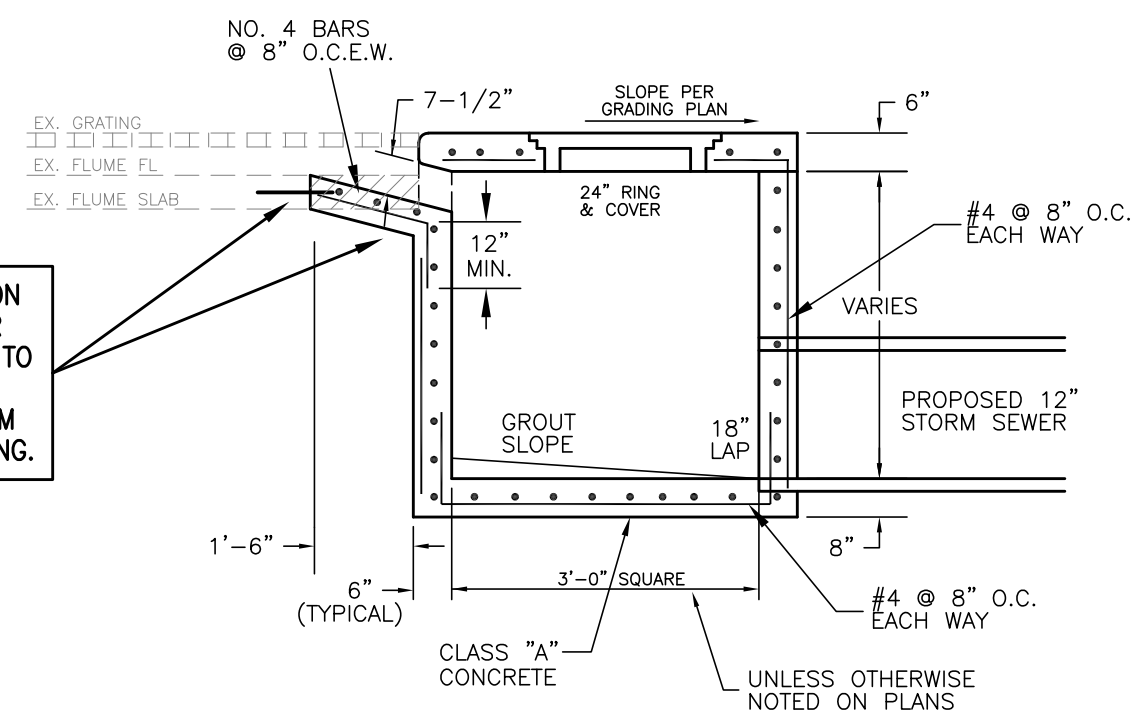

**STORM SEWER
PLAN - 400 BLOCK**

*CITY OF MARSHALL, TX.
DOWNTOWN REDEVELOPMENT PHASE III
300 & 400 BLOCK OF N. WASHINGTON AVENUE*

HAYES ENGINEERING, INC.
Texas Registered Engineering Firm E-1465

TEXAS REGISTERED ENGINEERING FIRM F-1465
2126 Alpine St. Longview, TX 75601-3401
Tel.: (903) 758-2010 • Fax: (903) 758-2099

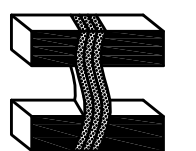

DRAWN BY : R.L.C.
CHECKED BY : S.R.H.
DATE : SEPT. 2023
SCALE : 1"=10'
JOB NO. : MA-21-01
MA-22-04

SHEET

15

OF **27** SHEETS